



# WINTERISE YOUR EQUIPMENT

A guide to products that should be drained of water to ensure equipment is safe from frost damage.



# CONTENTS

<b>Wheel Wash Systems</b>	<b>3</b>	<b>Armadillo</b>	<b>9</b>
<b>Enviro Wheel Wash 24</b>	<b>4</b>	<b>Armadillo 240V</b>	<b>10</b>
<b>Enviro Wheel Wash 14</b>	<b>5</b>	<b>Solor Loo</b>	<b>11</b>
<b>Water Tanks / Bowser and IBC</b>	<b>6</b>	<b>Solar Panels</b>	<b>12</b>
<b>Boot wash</b>	<b>7</b>	<b>Water System</b>	<b>13</b>
<b>110V &amp; 240V Pumps and Petrol Pumps with water pumping Facilit</b>	<b>8</b>		

## CERTIFICATIONS

Garic is certified with all of the following bodies, proving that our operations are always undertaken with heart, safety and environmental responsibility in mind.





# Wheel Wash Systems



**6" pumps for wheel wash systems require draining to ensure water does not freeze causing the pump to crack.**

**Open top tap**

**Simply open drain tap and allow water to run out.**

**Wheel wash baths drain water from pipework.**

**Open taps on pipework to enable water to drain out.**



# Enviro Wheel Wash 24

## Priming the pump for use/ draining for frost protection

To Prime the pump, you will need to open the ball valve (tap) on the top of the pump head, fill with clean water to the top and close the valve.

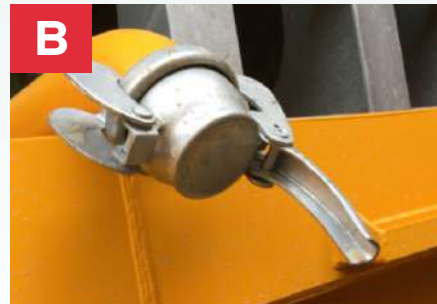

In frost conditions you will need to drain the head of water pump of half the water level and leave the ball valve open, so the handle is inline (a) (the image below shows the valve open). With regards to the wheel wash remove the bauer end caps (b), you will also need to open the drain tap on the central pipe (c) see opposite details and images.

# Enviro Wheel Wash 14

## Installing/connecting the pump/ draining for frost protection

- Pic A the pump is already pre-installed for immediate use, due to the pump being a submersible type, it does not require priming, it works by simply lowering into the water.
- In frost conditions you will need to lift the pump out of the water, which will then drain any residual water to prevent frost damage. (See warning details below).
- Pic B disconnect the power to the pump at the power control box as per image
- Pic C you will then need to disconnect the 4" bauer connection, below image.
- The pump is now ready to be lifted out.
- Place the magic eye which is housed inside the metal protection box on the remaining box section on the drivers notice sign (with the cut-out section for the sensor facing inwards of the ramps).
- Connecting water supply Pic D you will need to provide a constant water supply to the wash, using the 25mm alcatheine pipe connected to the ball cock system and turn the water supply on. The water will automatically stop when the unit is at the required level of approx 553 gallons.

**PLEASE NOTE DUE TO THE WEIGHT OF THE PUMP BEING 44kg THIS WILL REQUIRE LIFTING BY MECHANICAL AID.**

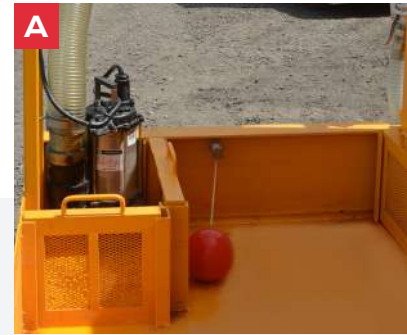



# Water Tanks & IBC



**If possible drain off water tanks if being left for a long period.**

**Drain IBC tanks when not being used for a long period.**



**If possible drain off water tanks if being left for a long period.**



# Boot Wash & Hand Wash Facilities



**Remove water supply and ensure taps are left open to allow water to drain.  
Failure to do this could result in pipework taps and hose splitting due to frost.**





# 110V & 240V pumps and petrol pumps with water pumping facility

If pumps are not in use ensure water supply is removed from pumps and also that pumps are drained.

Petrol pumps turn off water supply and completely drain the system including any hoses.

Remove the drain plug at the base of the pump housing and drain all water out, this will prevent it from freezing and damaging the pump. An insulated box can be constructed to place the on-demand pump in to protect it from the elements.

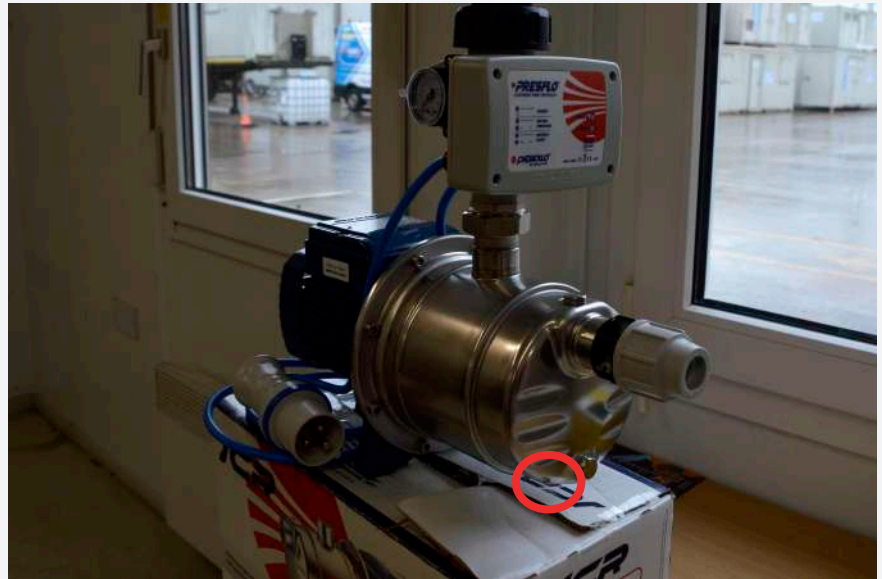



## Protecting your water system over the winter period

Allowing water to freeze in the system of your ArmadilloXL+2 unit may result in damage to the water pump and water heater.

To help prevent this from happening it is advised you follow the following procedures when unit is not being used over night, or left for long periods without use.



Remove blue fresh water pipe from the water container below the sink.



### Canteen area

Apply pressure to foot pedal, situated below sink in canteen area and leave to run until all the water has been pumped out of the system. This should take approximately 20-30 seconds.



### Toilet area

Apply pressure to foot pedal, situated below sink in the toilet area and leave to run until all the water has been pumped out of the system.



## To bring water system out of Winterised mode

1. Place fresh water pipe into Fresh water tank.
2. Turn dial to closed position on the tap.
3. Press the water pump switch in to power up and illuminate.
4. Re fit the filler cap on the Water cap in the Toilet area.
5. For Help or Advice on any of the points please call Garic TEL: 0844 8484560

# Armadillo 240v

## The winterisation procedure below refers to the water heating system installed in 240 Volt Armadillo units.

Allowing water to freeze in the system of your Armadillo unit may result in damage to the water pump and water heater.

To help prevent this from happening it is advised you follow the following procedures when unit is not being used over night, or left for long periods without use.



Remove the fresh water pipe from the tank below the sink



Turn the dial on the hand washer until the water has pumped out. Leave in open position for expansion

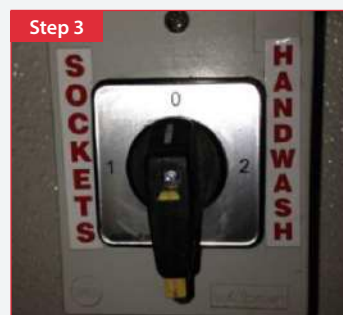

Turn the power selector switch to 0- neutral power



Switch off the hand washer mains isolator, located in the top right hand corner.



### Toilet area

In the toilet area remove the water filler cap. This prevents any expansion if freezing occurs (there is a heating element fitted).



## To bring water system out of Winterised mode

1. Place fresh water pipe into Fresh water tank.
2. Turn dial to closed position on Hand washer.
3. Turn power selector to Hand washer setting.
4. Switch Hand washer Mains Isolator to ON position.
5. Re fit the filler cap on the Water cap in the Toilet area.
6. Turn the switch on the Control panel to RUN the Generator will then start.
7. For Help or Advice on any of the points please call

# Solar Loo

## Frost Protection

- All Garic solar loos are fitted with frost protection which will start when the temperature drops below 3 degrees.
- For frost protection to automatically operate, it will need the diesel tank to be above  $\frac{1}{4}$  of a tank.
- Solar panels should be kept clean and any snow will need to be cleared.
- This is a fully insulated unit and the doors should always be kept closed.





# Solar Panels

- Solar panels should be free from dirt to allow peak efficiency.
- Snow must be removed to allow the panels to work efficiently.
- Even a light dusting can stop panels from working

## How to Clean Panels

1. Use a soft bristled brush or leaf blower to remove snow.
2. Use a hose pipe to spray panels.
3. Use warm soapy water to clean panels.



# Water System

## Protecting your water system over the winter period

Allowing water to freeze in the system of your groundhog unit may result in damage to the water pump and water heater. To help prevent this from happening it is advised you follow the following procedures when unit is not being used over night, or left for long periods without use.

**Location in canteen for:**

- a. ball fix valve
- b. fuse board

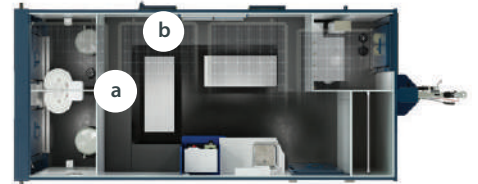

**Canteen area**

Remove blue fresh water pipe from the water container below the sink.



**Canteen area**

Apply pressure to foot pedal, situated below sink in canteen area and leave to run until all the water has been pumped out of the system. This should take approximately 20 seconds.



**Toilet areas**

Apply pressure to foot pedal, situated below the ceramic sink in both toilet areas and leave to run until all the water has been pumped out of the system.

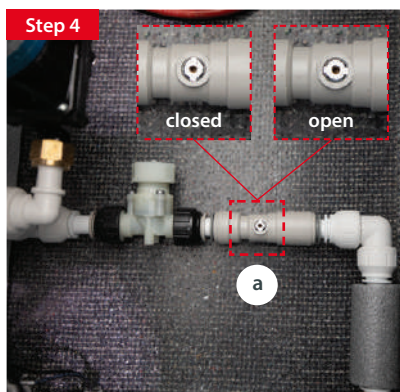

**Canteen area**

Located under the seating in the canteen area, isolate the ball fix valve, as shown by "a".



**Toilet areas**

Apply downward pressure to the toilet foot pedal in each toilet area as shown, and release when the water is pumped out of the system.

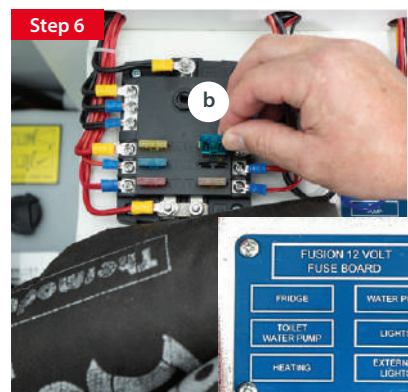

**Canteen area**

Located under the seating in the canteen area, remove the blue 15amp toilet pump fuse as shown.



(Layout may differ depending on model)



# Water System

## Protecting your water system over the winter period

Allowing water to freeze in the system of your groundhog unit may result in damage to the water pump and water heater. To help prevent this from happening it is advised you follow the following procedures when unit is not being used over night, or left for long periods without use.

To bring water heater system out of winterised mode, turn the ballfix valve to horizontal position. Water will then be available for use.

### NOTE:

It is good practice to release pressure within the water system. To do this, press percussion taps in toilet and canteen areas.



Go to the control panel in the messroom, press the "SYSTEM POWER" selector button to the "ON" position.

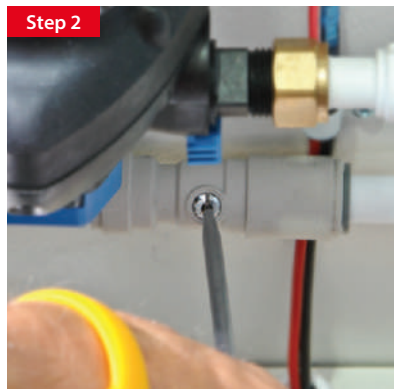

Turn ballfix valve, located under the desk in the office, to vertical position to turn off water supply.



Push and hold the tap in the messroom until the water stops flowing.



Make your way to the toilet room, then press and hold down the tap until the water stops flowing.



Apply downward pressure to the pedal until water flow stops flushing in both toilets.





Kingfisher Park, Aviation Road, Pilsworth, Bury, BL9 8GD  
info@garic.co.uk | www.garic.co.uk | 0330 094 8061



\* Weights and sizes shown may vary slightly. Garic reserve the right to change specification  
V1.2 Garic 2024